

PERTINENT DOCUMENTS AND SOURCES OF DATA USED:

- 1- DEED REFERENCES AS SHOWN HEREON
- 2- NEWTON TOWNSHIP TAX MAPS
- 3- U.S.G.S. MAPS
- 4- VARIOUS SURVEY RECORDS FOUND IN THE OFFICE OF THE MUSKONGUM COUNTY ENGINEER, ZANESVILLE, OHIO.

LINE TABLE

Id	Bearing	Distance
L1	S 85°19'58" W	192.21'
L2	S 53°59'36" W	67.60'
L3	S 42°38'19" W	207.80'
L4	S 41°48'06" W	143.05'
L5	S 37°25'53" W	100.00'
L6	S 35°21'53" W	100.00'
L7	S 41°46'43" W	100.01'
L8	S 51°42'05" W	100.00'
L9	S 55°32'51" W	106.39'
L10	S 59°17'53" W	89.66'
L11	S 59°17'53" W	195.00'
L12	S 68°41'08" W	154.20'

CURVE TABLE

Id	Delta	Radius	Arc Length	Chord	Ch Bear
C1	31°20'17"	1050.00'	574.30'	587.17'	S 69°40'51" W
C2	04°01'40"	5000.00'	351.50'	351.42'	S 57°17'03" W
C3	07°02'00"	500.00'	61.38'	61.34'	S 55°46'54" W
C4	16°25'12"	630.00'	180.55'	179.93'	S 60°28'31" W

NOTES:

- 1- THIS PLAT IS A DERIVATIVE OF A FIELD SURVEY PERFORMED BY OR UNDER THE DIRECT SUPERVISION OF WAYNE A. KNISLEY, OHIO P.S. #7231, ON NOVEMBER 29, 2021.
- 2- THIS PROPERTY IS SUBJECT TO ALL LEGAL HIGHWAYS, ALL RESTRICTIONS AND EASEMENTS OF RECORD.
- 3- ALL DISTANCES ARE MEASURED UNLESS OTHERWISE SHOWN.

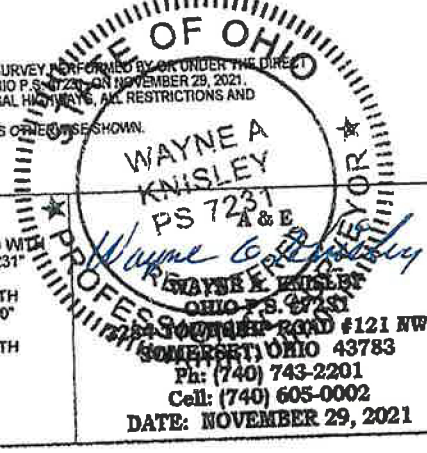

- LEGEND**
- ⊕ IRON PIN SET = 5/8" BY 30" STEEL ROD WITH PLASTIC ID. CAP MARKED "KNISLEY 7231"
 - ⊙ EXISTING IRON PIN = 5/8" IRON PIN WITH PLASTIC ID. CAP MARKED "EMLER 7760"
 - EXISTING IRON PIN = 3/4" IRON PIN WITH ALUMINUM CAP MARKED "APS 7103"
 - ⊙ EXISTING CORNER STONE
 - UNMARKED POINT



JOB # K202123P

KAUFMAN REALTY & MILLER

SURVEY FOR:

